

Basic socket series designation for:
SERIES M300, M301, M302,
M400, T401, T402, T412

• **Designed to the standards and requirements of:**

Conforme aux exigences des normes et spécifications:

2-pole, 10A relays

Mates with / Modèles compatibles

4-pole, 10A relays

Mates with / Modèles compatibles

MIL-PRF-12883/41

M83536, M83726 and MS27709

MIL-PRF-12883/40

M83536

PRINCIPAL TECHNICAL CHARACTERISTICS CARACTERISTIQUES TECHNIQUES PRINCIPALES

• **Low profile**

Bas profil

• **Bottom panel mount**

Montage sur panneau

• **Snaps into panel**

Encliquetable sur panneau

• **Special models available upon request**

Modèles spécifiques sur demande

MATERIALS MATERIAUX

• **Socket body:**

Corps

Polyetherimide per MIL-P-46184

• **Grommet:**

Joint d'étanchéité

Silicone rubber per ZZ-R-765

• **Hardware:**

Visserie

Stainless Steel

• **Contacts:**

Contacts

Copper alloy, hard gold plated per MIL-G-45204

• **Contact retainers:**

Clips de retenu

Beryllium copper

GENERAL CHARACTERISTICS CARACTERISTIQUES GENERALES

Insulation resistance <i>Résistance d'isolement</i>	1000 M W min.
Dielectric withstanding voltage <i>Rigidité diélectrique</i>	1500 VRMS sea level; 500 VRMS at 25,000 m
Weight <i>Masse</i>	15.3g max.
Temperature range <i>Gamme de température</i>	-65°C to +125°C
Vibration <i>Vibration</i>	MIL-STD-202, Method 204, Test Condition G
Shock <i>Chocs</i>	MIL-STD-202, Method 213, Test Condition C

AMERICAS.

Tel: +1 714-736-7599

<http://www.esterline.com/powersystems>

EUROPE.

Tel: +33 3 87 97 31 01

Fax: +33 3 87 97 96 86

ASIA

Tel: +852 2 191 3830

Fax: +852 2 389 5803

Dimensions in mm
 Tolerances, unless otherwise specified, ±0.25mm

TERMINAL LAYOUT (2 POLE)
TYPE DE SORTIE (2 POLES)

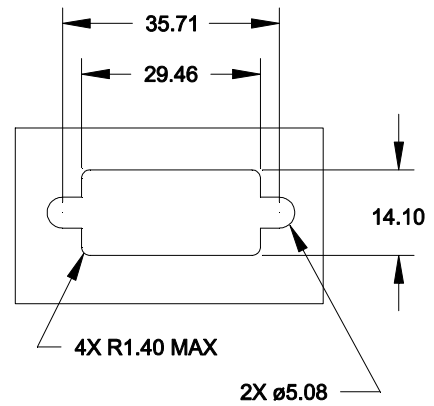
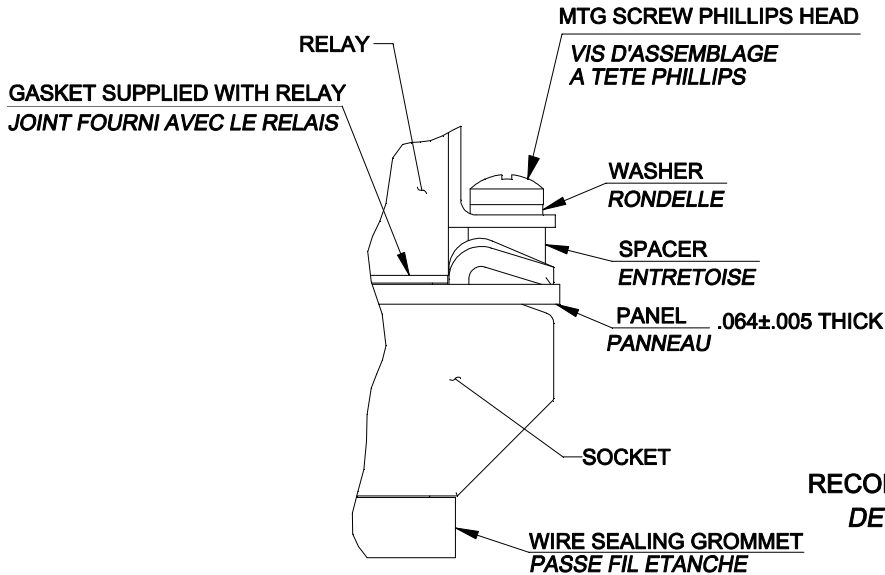

RECOMMENDED MOUNTING PANEL CUTOUT
DECOUPE DE PANNEAU CONSEILLEE

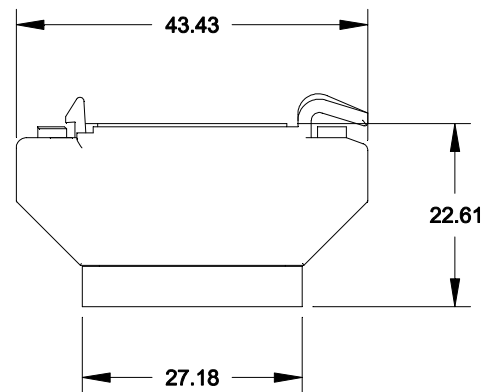
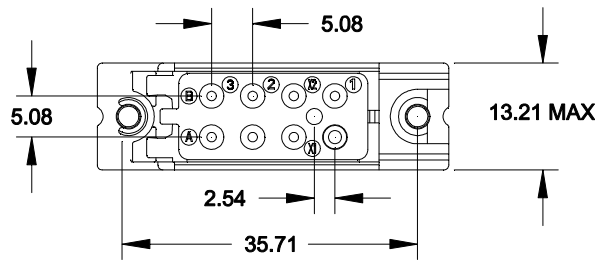

TERMINAL LAYOUT (2 POLE)
TYPE DE SORTIE (2 POLES)

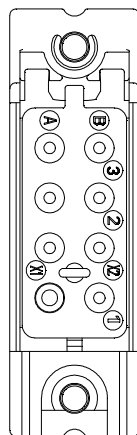

SC301-2

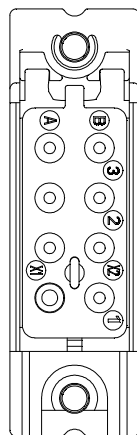

SC301-1

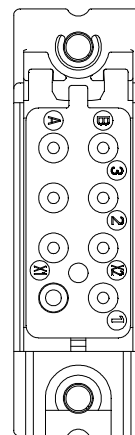

SC300

TERMINAL LAYOUT (4 POLE) TYPE DE SORTIE (4 POLES)

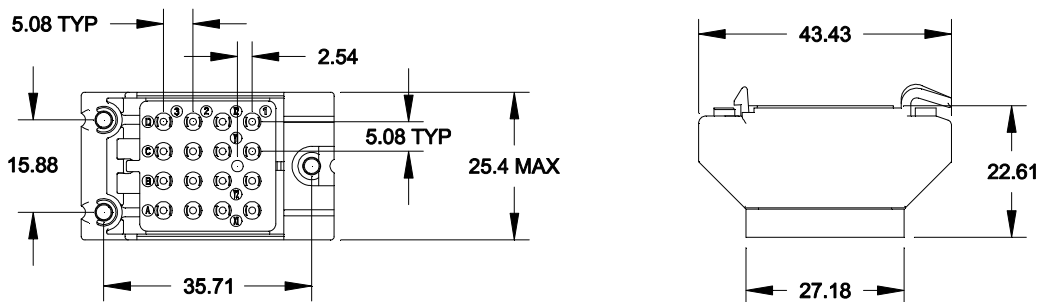
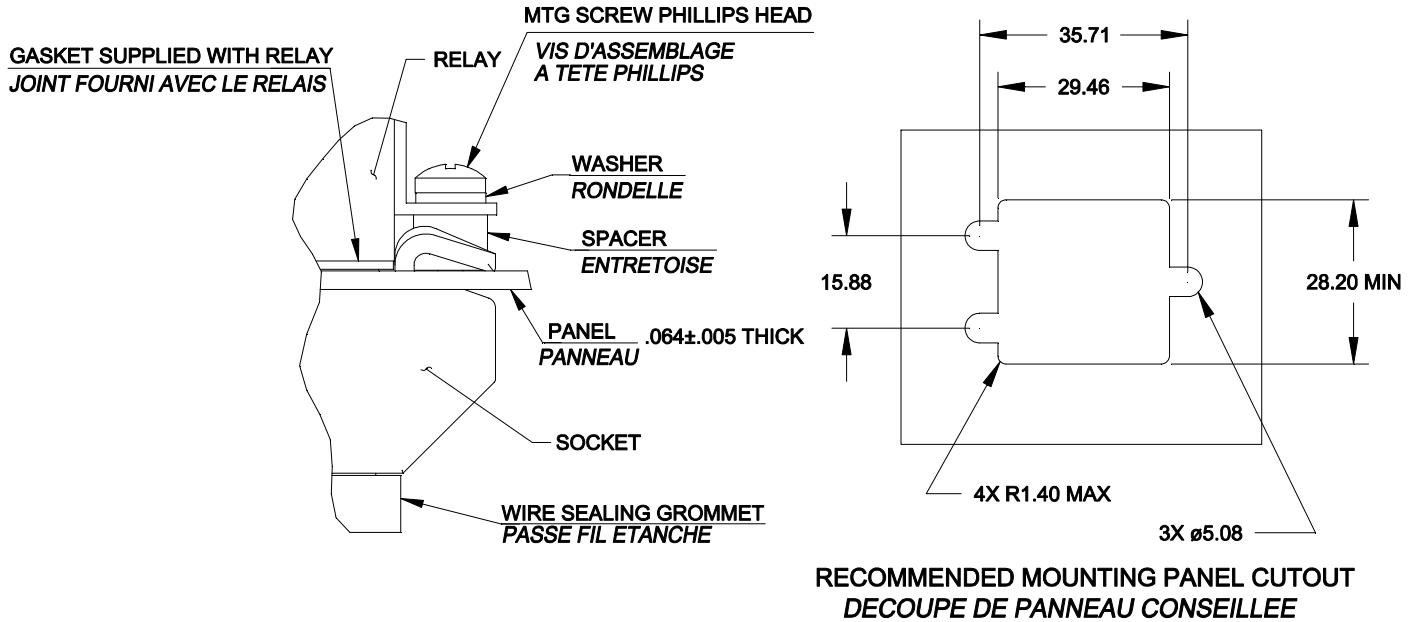

TERMINAL LAYOUT (4 POLE) TYPE DE SORTIE (4 POLES)

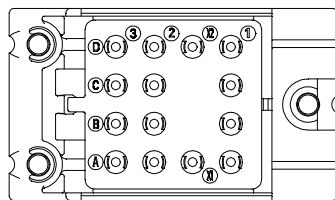

SC400

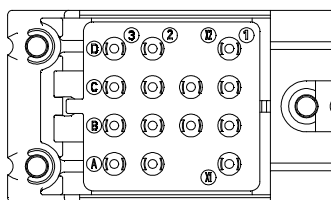

SC401-1

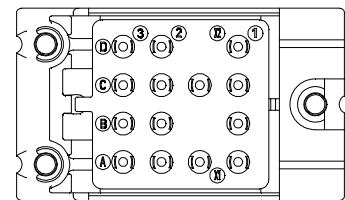

SC401-2

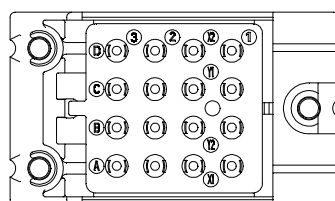

SC402

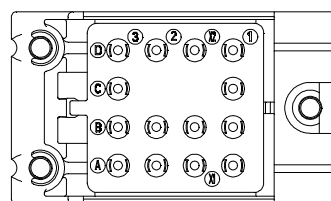

SCTDX-1

SOCKET NUMBERING SYSTEM
SYSTEME DE REFERENCES

Basic socket snap lock designation | *Socle de base encliquetable*

1. **Mating relay** | *type de relais*
2. **Hardware** | *Visserie (0=sans visserie, 1=avec visserie)*
3. **Contacts** | *Contacts (0=sans contacts, 1=avec contacts)*

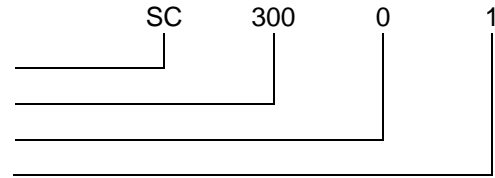

Exemple : SC3001